



CJBC CJBC/ECO

CJBC: Compact extraction units direct drive for community housing

CJBC/ECO: Compact extraction units direct drive for community housing with constant pressure control.

Fan:

- Galvanised sheet steel structure with thermal insulation and soundproofing.
- Impeller with forward-facing blades made from galvanised sheet steel
- Stuffing-box for cable inlet
- CJBC/ECO: It incorporates a low-pressure switch and speed regulator by means of a frequency converter to maintain a constant pressure

Motor:

- Class F closed motors with incorporated thermal protector, ball bearings and IP-54 protection
- Single-phase 220-240V.-50Hz. and three-phase 220-240/380-415V.-50Hz.
- Max. air temperature to transport: -20°C.+60°C.

Finish:

- Anticorrosive galvanized sheet steel

On request:

- With circular inlet



CJBC



CJBC/ECO

Example of use

SELF-REGULATED CONTROL OPTION



CJBC



BE ALIZE



EA



HYGRO-REGULATED CONTROL OPTION



CJBC/ECO



BE ALIZE-H



EA-A-HY

Order code

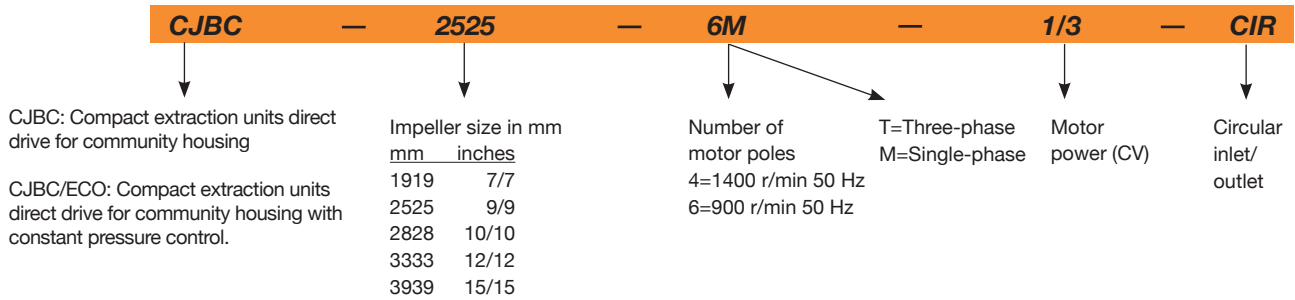

Technical characteristics

Model	Speed (r/min)	Equivalent Inches	Maximum admissible current (A)		Installed power (kW)	Maximum airflow (m³/h)	Irradiated* dB(A)	Approx. weight (Kg)
			230V	400V				
CJBC-1919-4M 1/5	1230	7/7	1.40		0.15	1368	58	15.7
CJBC-1919-6M 1/10	820	7/7	0.85		0.08	1107	53	15.7
CJBC-2525-4M 3/4	1310	9/9	4.50		0.55	3240	70	23.3
CJBC-2525-6M 1/3	830	9/9	2.20		0.25	2430	61	22.3
CJBC-2828-4M 3/4	1310	10/10	4.50		0.55	3555	70	27.3
CJBC-2828-6M 1/3	830	10/10	2.20		0.25	2880	61	26.2
CJBC-3333-6M 1	850	12/12	6.00		0.75	5400	70	38.3
CJBC-3333-6T 1 1/2	850	12/12	6.60	3.80	1.10	7020	74	38.7
CJBC-3939-6T 3	890	15/15	10.90	6.30	2.20	10710	74	58.0
CJBC/ECO-3333-6T 1 1/2	850	12/12	6.60	3.80	1.10	7020	74	40.7
CJBC/ECO-3939-6T 3	890	15/15	10.90	6.30	2.20	10710	74	60.0



Erp. BEP (best efficiency point) characteristics

Available features best efficiency point (BEP), CBD series

Acoustic features

The specified values are determined according to free field measurements of sound levels in dB(A) at an equivalent distance of twice the fan's span plus the impeller's diameter, with a minimum of 1.5 m.

Sound power Lw(A) spectrum in dB(A) via frequency band in Hz. Maximum speed

Model	63	125	250	500	1000	2000	4000	8000	Model	63	125	250	500	1000	2000	4000	8000
CJBC-1919-4M 1/5	43	54	58	62	64	63	62	53	CJBC-3333-6M 1	55	66	70	74	76	75	74	65
CJBC-1919-6M 1/10	38	49	53	57	59	58	57	48	CJBC-3333-6T 1 1/2	59	70	74	78	80	79	78	69
CJBC-2525-4M 3/4	55	66	70	74	76	75	74	65	CJBC-3939-6T 3	61	72	77	81	83	81	80	71
CJBC-2525-6M 1/3	46	57	61	65	67	66	65	56	CJBC/ECO-3333-6T 1 1/2	59	70	74	78	80	79	78	69
CJBC-2828-4M 3/4	55	66	70	74	76	75	74	65	CJBC/ECO-3939-6T 3	61	72	77	81	83	81	80	71
CJBC-2828-6M 1/3	46	57	61	65	67	66	65	56									



Version with circular inlet/outlet

Dimensions in mm

CJBC

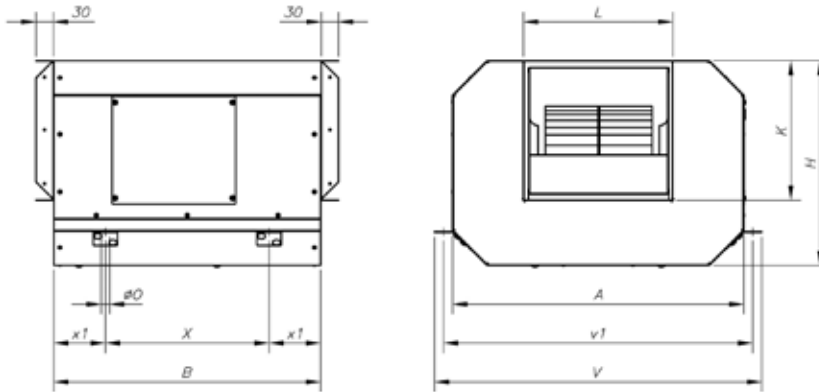

Model	A	B	H	K	L	øO	V	v1	X	x1
CJBC-1919-4M -1/5	480	440	340	210	225	15	540	510	270	85
CJBC-1919-6M -1/10	480	440	340	210	225	15	540	510	270	85
CJBC-2525-4M -3/4	630	575	405	265	291	15	690	660	375	100
CJBC-2525-6M -1/3	630	575	405	265	291	15	690	660	375	100
CJBC-2828-4M -3/4	696	645	460	290	320	15	755	725	445	100
CJBC-2828-6M -1/3	696	645	460	290	320	15	755	725	445	100
CJBC-3333-6M -1	825	760	535	345	379	15	885	855	510	125
CJBC-3333-6T -1 1/2	825	760	535	345	379	15	885	855	510	125
CJBC-3939-6T -3	910	900	636	405	467	15	970	940	650	125

CJBC/ECO

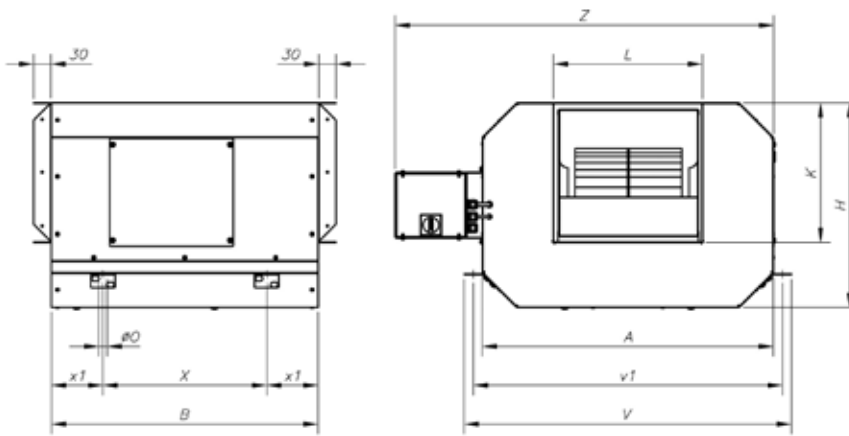

Model	A	B	H	K	L	øO	V	v1	X	x1	Z
CJBC/ECO-3333-6T -1 1/2	825	760	535	345	379	15	885	855	510	125	1080
CJBC/ECO-3939-6T -3	910	900	636	405	467	15	970	940	650	125	1200

Characteristic Curves

Q = Airflow in m³/h, m³/s and cfm.

Pe = Static pressure in mm.w.c., Pa and inwg.

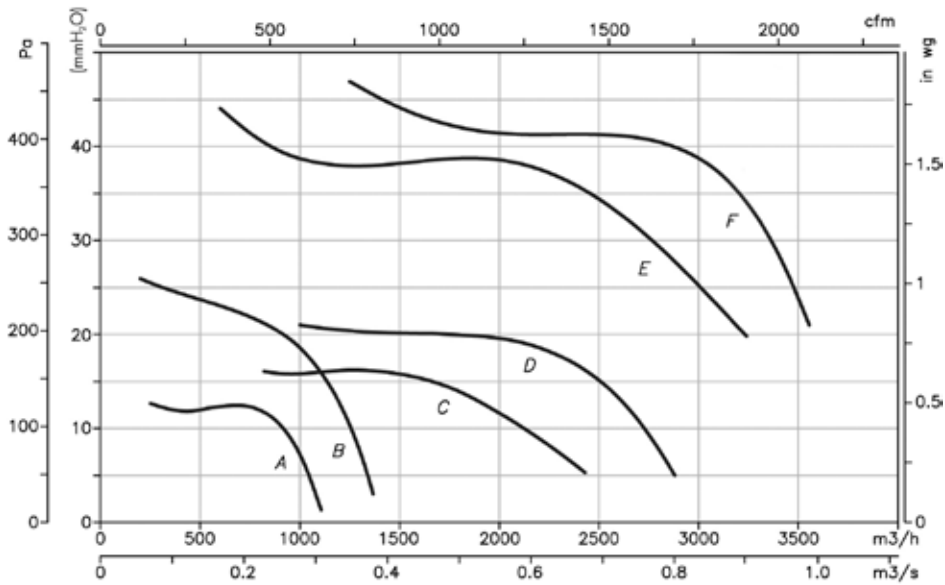

- A: 1919-6M 1/10
- B: 1919-4M 1/5
- C: 2525-6M 1/3
- D: 2828-6M 1/3
- E: 2525-4M 3/4
- F: 2828-4M 3/4

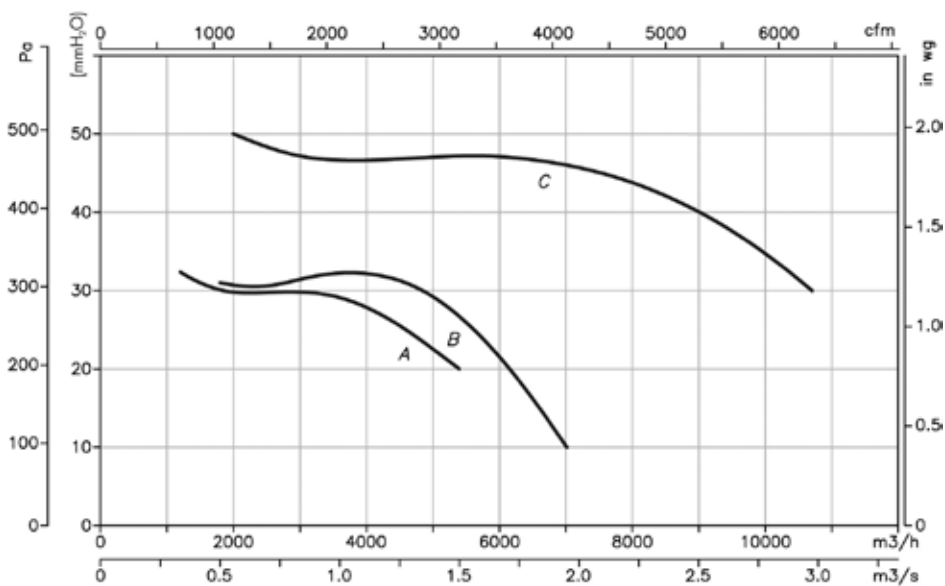

- A: 3333-6M 1
- B: 3333-6T 1 1/2
- C: 3939-6T 3

Accessories

See accessories section.



Electronic speed controllers



Output openings for houses



Inlet/Outlet



Air intakes for houses



Intelligent sensors



Silencer



Plenum



Circular cover